

| Steel Frame | Board Type | Weight | Main Spacing (L1) | Sub Spacing (L2) | Hanging Spacing (Lp) |
|-------------|------------|-------------------|-------------------|------------------|----------------------|
| | | kg/m ² | cm. | cm. | cm. |
| ML50A | 1-RE9mm. | 6.77 | 120 | 40 | 120 |
| ML50A | 1-RE12mm. | 8.65 | 100 | 60 | 100 |
| ML50A | 1-RE15mm. | 10.87 | 90 | 60 | 100 |
| ML50A | 1-FS1/2" | 9.33 | 90* | 60* | 100* |
| ML50A | 1-FSS/8" | 11.91 | 90* | 60* | 100* |
| ML50A | 1-Gyptone | 8.02 | 60 | 60 | 100 |
| ML50A | 2-FS1/2" | 18.66 | 80* | 60* | 100* |
| ML50A | 2-FSS/8" | 23.82 | 60* | 60* | 100* |
| ML50A | 1-MR9mm. | 7.43 | 120 | 40 | 120 |
| ML50A | 1-MR12mm. | 9.55 | 100 | 60 | 100 |
| XL50 | 1-RE9mm. | 6.77 | 120 | 40 | 120 |
| XL50 | 1-RE12mm. | 8.65 | 120 | 60 | 120 |
| XL50 | 1-RE15mm. | 10.87 | 120 | 60 | 120 |
| XL50 | 1-FS1/2" | 9.33 | 120* | 60* | 120* |
| XL50 | 1-FSS/8" | 11.91 | 120* | 60* | 120* |
| XL50 | 1-Gyptone | 8.02 | 60 | 60 | 120 |
| XL50 | 2-FS1/2" | 18.66 | 100* | 60* | 100* |
| XL50 | 2-FSS/8" | 23.82 | 90* | 60* | 100* |
| XL50 | 1-MR9mm. | 7.43 | 120 | 40 | 120 |
| XL50 | 1-MR12mm. | 9.55 | 120 | 60 | 120 |

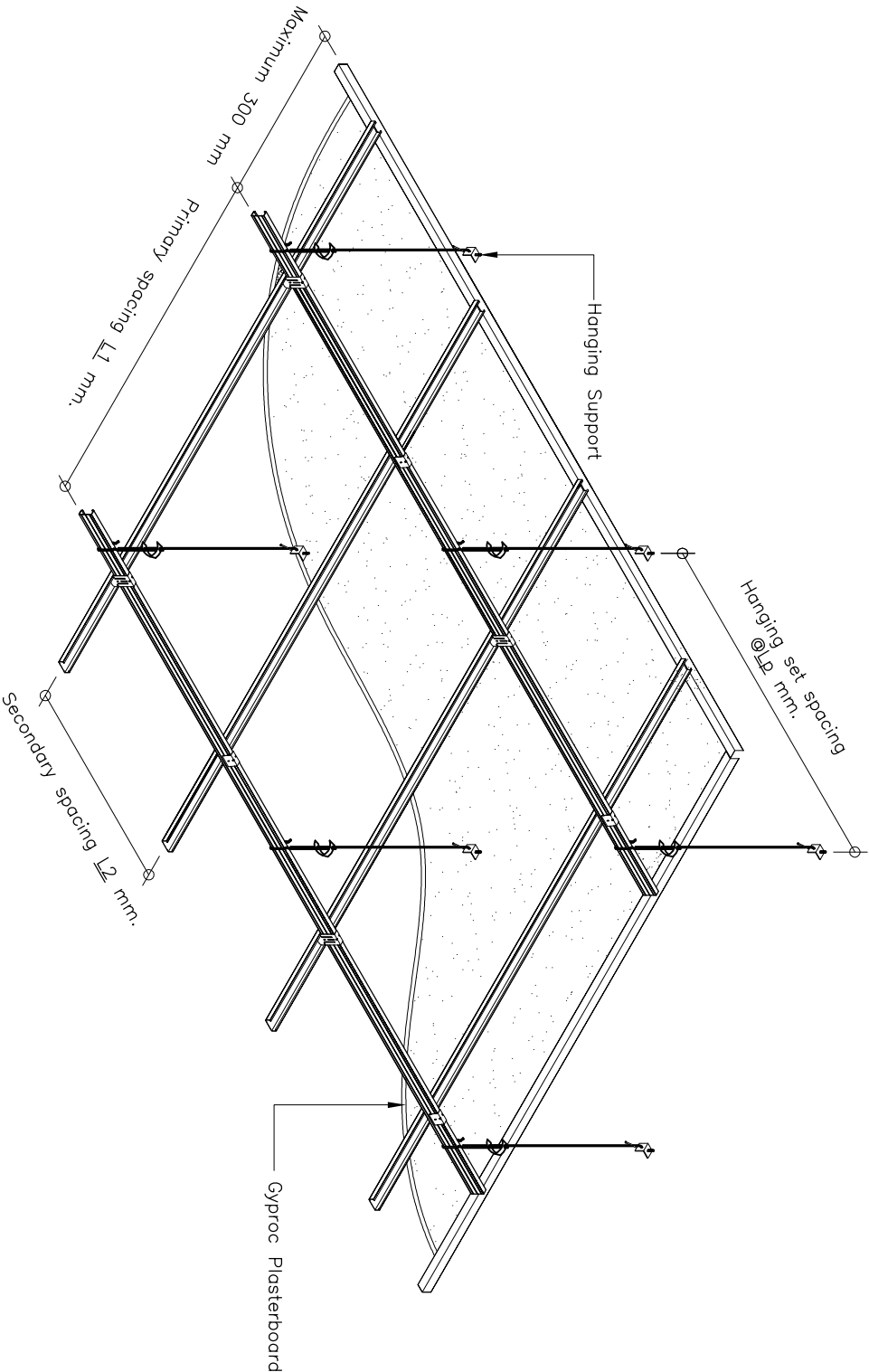

Note: * are framing systems without fire performances (for board weight carriage only)

Technical Center

Title :

Concealed Grid : Isometric Drawing with Suspension Hook & Rod System

| | | |
|------------|---|-------------|
| Dwg no. : | Scale : | Date : |
| - | None | 21 Nov 2013 |
| Approved : | File Ref : | |
| Supoj T. | Package4.1REV1 - Concealed Grid : Installation Standard.dwg | |



This drawing is provided to customers free of charge and the details show are subject to the accuracy of the information provided to Thai Gypsum at the time the drawing was originally requested. As a result of this sole liability for the details show cannot be accepted by Thai Gypsum, the drawing should therefore be approved by the project design and management authority before use to ensure that it meets with their specific project requirements. It should also be read in conjunction with Thai Gypsum's current literature available at www.thaigypsum.com - Topping and finishing in accordance with Thai Gypsum's current recommendations is assumed - We would also draw your attention to the Construction (Design and Management) which detail the legal duties of clients, clients' agents, designers and contractors involved in construction projects.

| Steel Frame | Board Type | Weight | Main Spacing (L1) | Sub Spacing (L2) | Hanging Spacing (Lp) |
|-------------|------------|-------------------|-------------------|------------------|----------------------|
| | | kg/m ² | cm. | cm. | cm. |
| ML50A | 1-RE9mm. | 6.77 | 120 | 40 | 120 |
| ML50A | 1-RE12mm. | 8.65 | 100 | 60 | 100 |
| ML50A | 1-RE15mm. | 10.87 | 90 | 60 | 100 |
| ML50A | 1-FS1/2" | 9.33 | 90* | 60* | 100* |
| ML50A | 1-FS5/8" | 11.91 | 90* | 60* | 100* |
| ML50A | 1-Gyptone | 8.02 | 60 | 60 | 100 |
| ML50A | 2-FS1/2" | 18.66 | 80* | 60* | 100* |
| ML50A | 2-FS5/8" | 23.82 | 60* | 60* | 100* |
| ML50A | 1-MR9mm. | 7.43 | 120 | 40 | 120 |
| ML50A | 1-MR12mm. | 9.55 | 100 | 60 | 100 |
| XL50 | 1-RE9mm. | 6.77 | 120 | 40 | 120 |
| XL50 | 1-RE12mm. | 8.65 | 120 | 60 | 120 |
| XL50 | 1-RE15mm. | 10.87 | 120 | 60 | 120 |
| XL50 | 1-FS1/2" | 9.33 | 120* | 60* | 120* |
| XL50 | 1-FS5/8" | 11.91 | 120* | 60* | 120* |
| XL50 | 1-Gyptone | 8.02 | 60 | 60 | 120 |
| XL50 | 2-FS1/2" | 18.66 | 100* | 60* | 100* |
| XL50 | 2-FS5/8" | 23.82 | 90* | 60* | 100* |
| XL50 | 1-MR9mm. | 7.43 | 120 | 40 | 120 |
| XL50 | 1-MR12mm. | 9.55 | 120 | 60 | 120 |

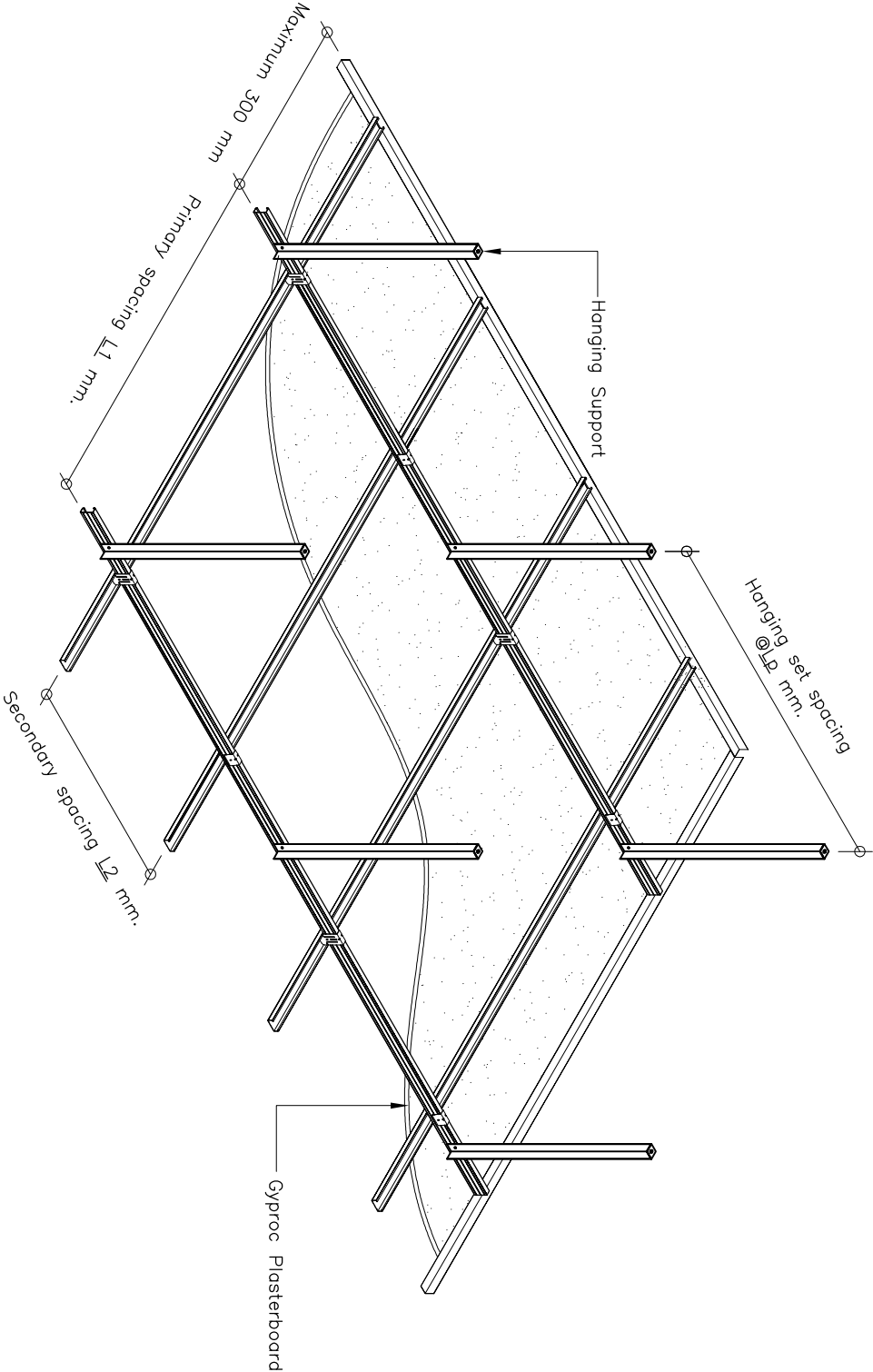

Note: * are framing systems without fire performances (for board weight carriage only)

Technical Center

Title :

Concealed Grid : Isometric Drawing with Steel Angle System

| | | | |
|------------|---|-------------|--|
| Dwg no. : | Scale : | Date : | |
| - | | 21 Nov 2013 | |
| Approved : | File Ref : | None | |
| Supoj T. | Package4.1REV1 - Concealed Grid : Installation Standard.dwg | | |



This drawing is provided to customers free of charge and the details show are subject to the accuracy of the information provided to Thai Gypsum at the time the drawing was originally requested. As a result of this sole liability for the details show cannot be accepted by Thai Gypsum. the drawing should therefore be approved by the project design and management authority before use to ensure that it meets with their specific project requirements. It should also be read in conjunction with Thai Gypsum's current literature available at www.thaigypsum.com - Topping and finishing in accordance with Thai Gypsum's current recommendations is assumed - We would also draw your attention to the Construction (Design and Management) which detail the legal duties of clients, client's agents, designers and contractors involved in construction projects.

This drawing is provided to customers free of charge and the details show are subject to the accuracy of the information provided to Thai Gypsum at the time the drawing was originally requested. As a result of this sole liability for the details show cannot be accepted by Thai Gypsum. the drawing should therefore be approved by the project design and management authority before use to ensure that it meets with their specific project requirements. It should also be read in conjunction with Thai Gypsum's current literature available at www.thaigypsum.com - Topping and finishing in accordance with Thai Gypsum's current recommendations is assumed - We would also draw your attention to the Construction (Design and Management) which detail the legal duties of clients, client's agents, designers and contractors involved in construction projects.

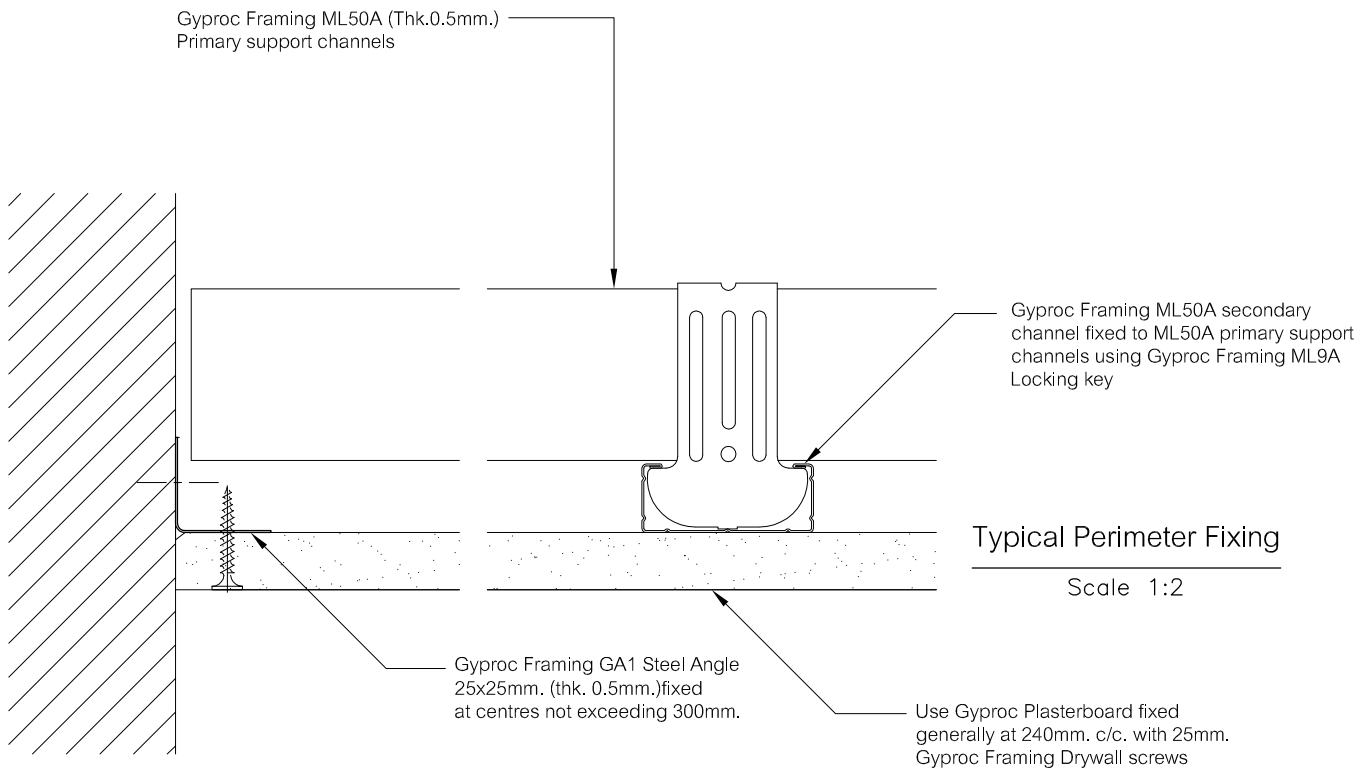

Technical Center

| | | |
|---|---|-------------|
| Title : | | |
| Concealed Grid : Detail - Connecting Primary & Secondary Frame with Connecting Clip | | |
| Dwg no. : | Scale : | Date : |
| - | None | 21 Nov 2013 |
| Approved : | File Ref : | |
| Supoj T. | Package4.1REV1 - Concealed Grid : Installation Standard.dwg | |



This drawing is provided to customers free of charge and the details show are subject to the accuracy of the information provided to Thai Gypsum at the time the drawing was originally requested. As a result of this sole liability for the details show cannot be accepted by Thai Gypsum. the drawing should therefore be approved by the project design and management authority before use to ensure that it meets with their specific project requirements. It should also be read in conjunction with Thai Gypsum's current literature available at www.thaigypsum.com - Topping and finishing in accordance with Thai Gypsum's current recommendations is assumed - We would also draw your attention to the Construction (Design and Management) which detail the legal duties of clients, client's agents, designers and contractors involved in construction projects.

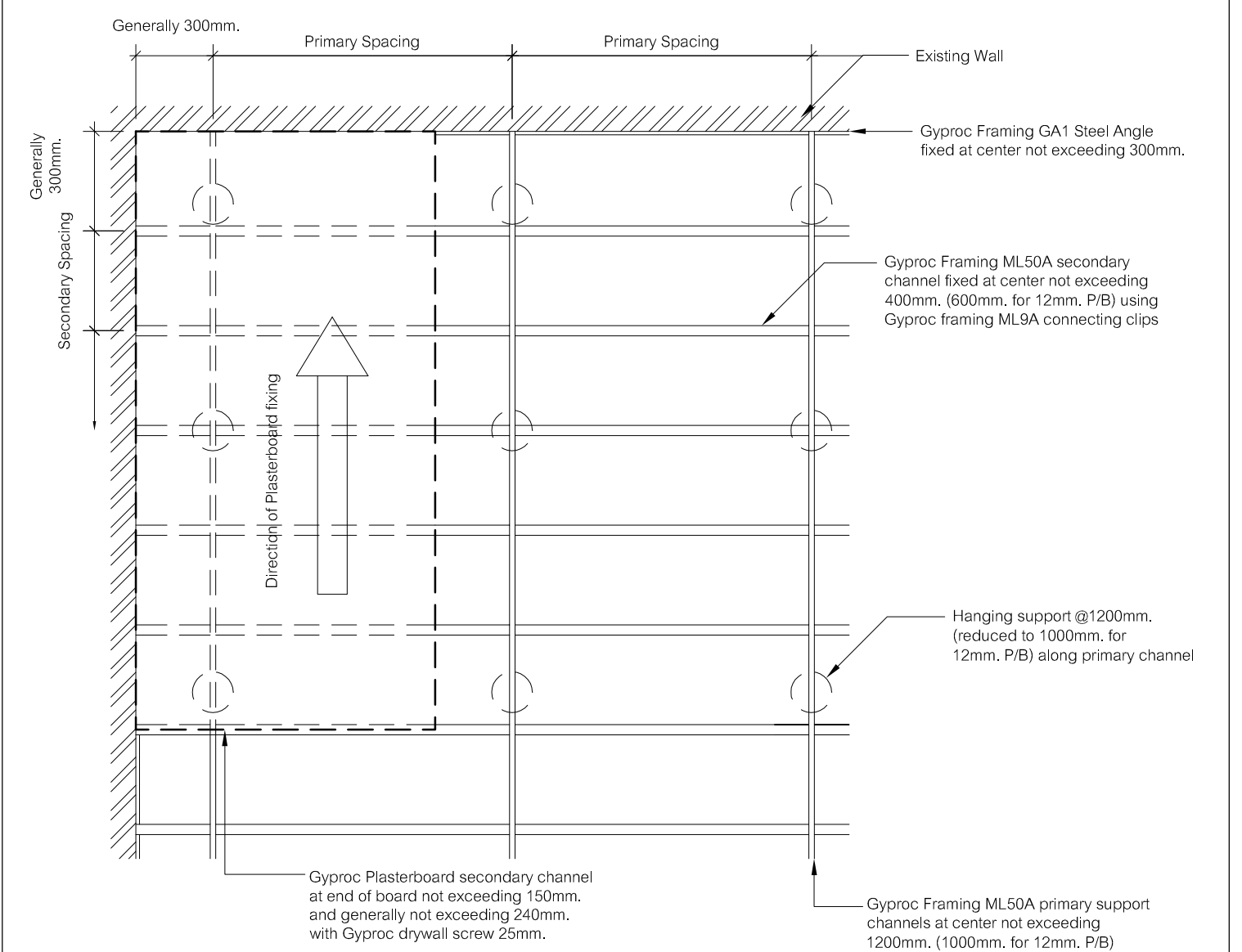

Technical Center

| | | |
|---|---|-------------|
| Title : | | |
| Concealed Grid : Plan - Frame and Board Fixing for Single Layer | | |
| Dwg no. : | Scale : | Date : |
| - | None | 21 Nov 2013 |
| Approved : | File Ref : | |
| Supoj T. | Package4.1REV1 - Concealed Grid : Installation Standard.dwg | |



This drawing is provided to customers free of charge and the details show are subject to the accuracy of the information provided to Thai Gypsum at the time the drawing was originally requested. As a result of this sole liability for the details show cannot be accepted by Thai Gypsum. the drawing should therefore be approved by the project design and management authority before use to ensure that it meets with their specific project requirements. It should also be read in conjunction with Thai Gypsum's current literature available at www.thaigypsum.com - Topping and finishing in accordance with Thai Gypsum's current recommendations is assumed - We would also draw your attention to the Construction (Design and Management) which detail the legal duties of clients, client's agents, designers and contractors involved in construction projects.

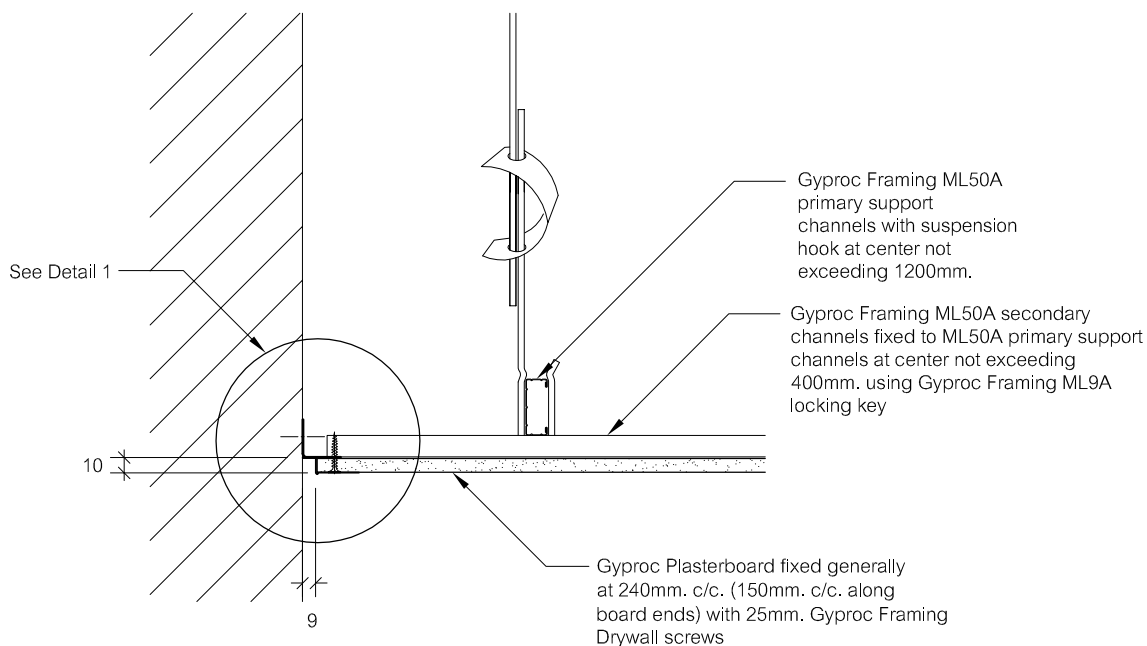

Shadow Line Installation

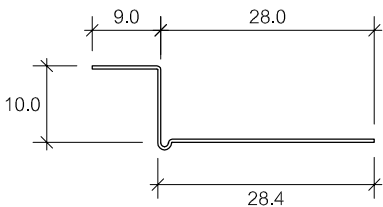

Shadow Line Dimension
Scale 1:1

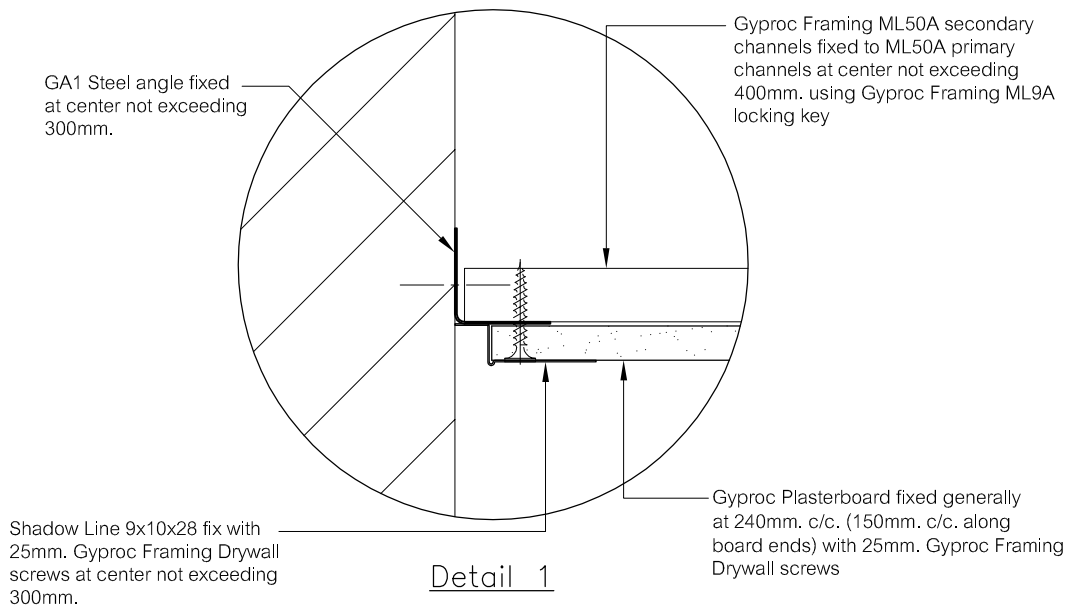

Technical Center

| | | |
|--|---|-------------|
| Title : | | |
| Concealed Grid : Detail - with Shadow Line | | |
| Dwg no. : | Scale : | Date : |
| - | None | 21 Nov 2013 |
| Approved : | File Ref : | |
| Supoj T. | Package4.1REV1 - Concealed Grid : Installation Standard.dwg | |



This drawing is provided to customers free of charge and the details show are subject to the accuracy of the information provided to Thai Gypsum at the time the drawing was originally requested. As a result of this sole liability for the details show cannot be accepted by Thai Gypsum. the drawing should therefore be approved by the project design and management authority before use to ensure that it meets with their specific project requirements. It should also be read in conjunction with Thai Gypsum's current literature available at www.thaigypsum.com - Topping and finishing in accordance with Thai Gypsum's current recommendations is assumed - We would also draw your attention to the Construction (Design and Management) which detail the legal duties of clients, client's agents, designers and contractors involved in construction projects.

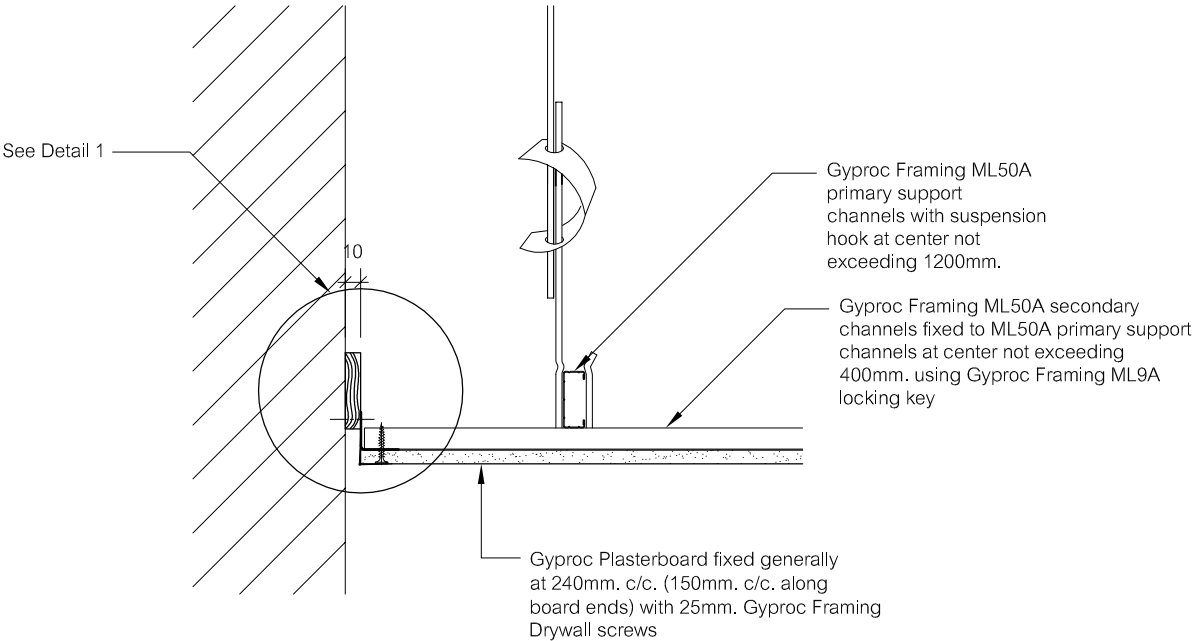

Shadow line Manual Installation

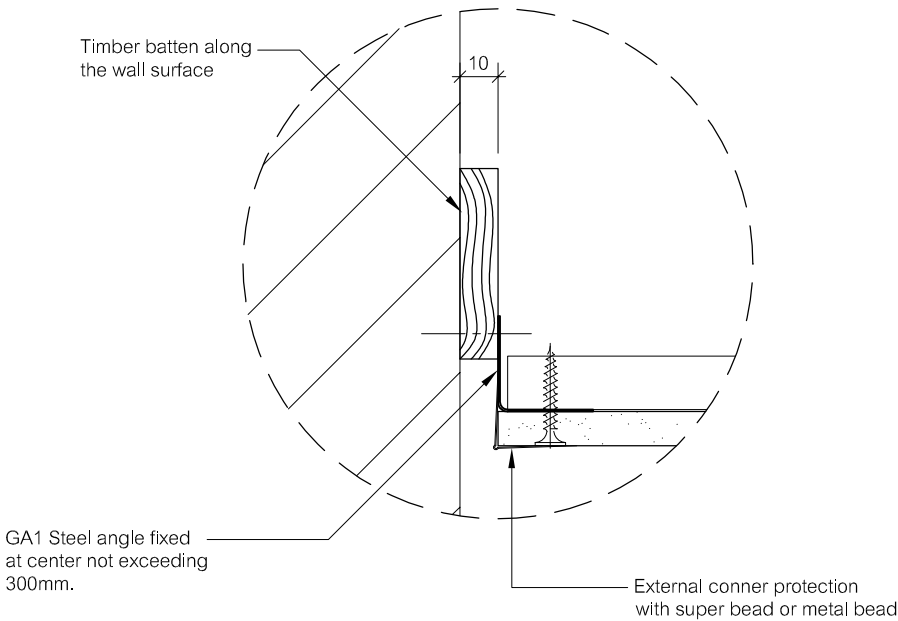

Detail 1

Technical Center

| | | |
|---|---|-------------|
| Title : | | |
| Concealed Grid : Detail - without Shadow Line | | |
| Dwg no. : | Scale : | Date : |
| - | None | 21 Nov 2013 |
| Approved : | File Ref : | |
| Supoj T. | Package4.1REV1 - Concealed Grid : Installation Standard.dwg | |



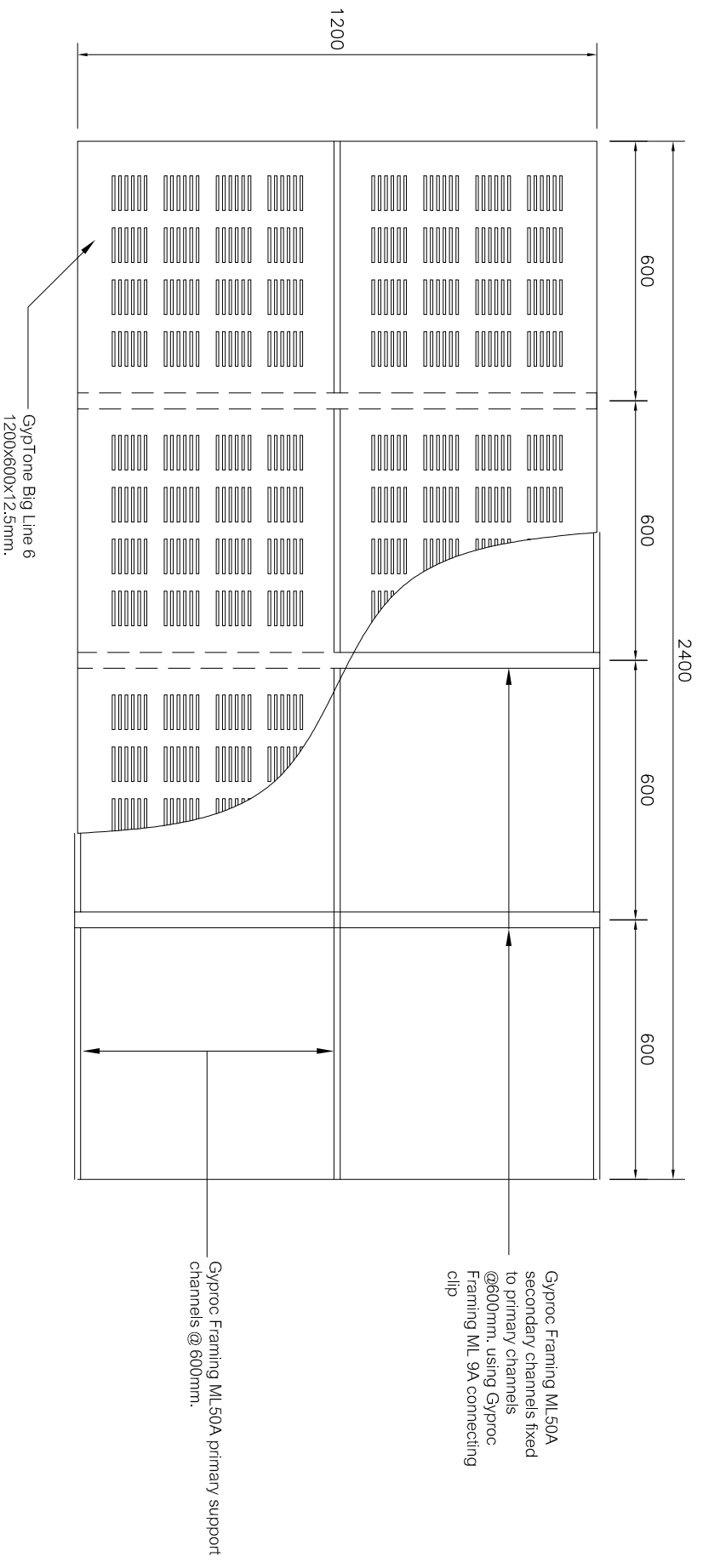

Technical Center

Title :

Concealed Grid : Example arrange of Gyproc Framing Layout for Gypstone

This drawing is provided to customers free of charge and the details show are subject to the accuracy of the information provided to Thai Gypsum at the time the drawing was originally requested. As a result of this sole liability for the details show cannot be accepted by Thai Gypsum, the drawing should therefore be approved by the project design and management authority before use to ensure that it meets with their specific project requirements. It should also be read in conjunction with Thai Gypsum's current literature available at www.thaigypsum.com - Topping and finishing in accordance with Thai Gypsum's current recommendations is assumed - We would also draw your attention to the Construction (Design and Management) which detail the legal duties of clients, client's agents, designers and contractors involved in construction projects.

| | | |
|------------|--|--------|
| Dwg no. : | Scale : | Date : |
| Approved : | File Ref : | |
| Supoj T. | Packaged4.1REV1 - Concealed Grid : Installation Standard.dwg | |

